



Application: 1997-2004 C5 Corvette

Part Includes

- 2 - Stainless Vent Grilles w/ Attachment Tape
- 2 - Adhesive Promoter Packs
- 2 - 23" x 1/8" Chrome Trim (Optional)
- 2 - Alcohole Swabs

Side Cove Screens



Tools Needed



STEP 1.

Place the car on jack stands for easier access. Turn wheels to one side to gain access to work area.

STEP 2.

Remove fender well screws to gain access to vent area. Remove three screws under car at the side vent opening.

STEP 3.

Pull fender outward. Remove the two 7mm screws at the lip of the fender well that hold the inner fender panel deflector in place. Remove the deflector and set aside.

STEP 4.

Clean mounting area inside and out, using soap and water to remove dirt and grime, then clean with the included alcohol pads, the cleaner the better.

STEP 5.

Do not remove tape backing on vent grille yet, do a dry run fitting to determine left and right hand grilles. Reshape to obtain the desired fit. Simply reshape with hands and dry fit it again. When satisfied with fit, remove backing tape and apply the supplied adhesive promoter for a more secure fit.

STEP 6.

Install vent grille in place and press into place with hands. Keep applying pressure to make sure grille is bonded securely. Reattach the inner fender deflector, then the fender well, and don't forget the three screws under the fender. Repeat for the other side.



Two screws need to be removed



Three screws need to be removed; two vertical and one horizontal.

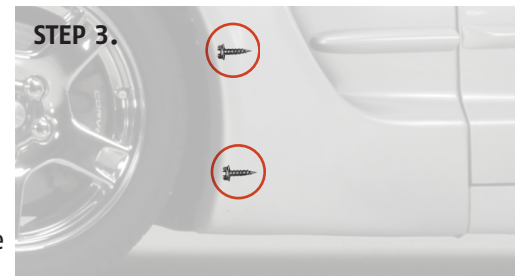

Two screws need to be removed



MAMotorworks



Midamotorworks



MidAmericaMotorworks

2900 N. Third Street, P.O. Box 1368, Effingham, IL 62401
800.500.1500 • Worldwide: 217.540.4200 • FAX: 217.540.4800
www.mamotorworks.com • generalmail@mamotorworks.com
©Mid America Motorworks, Inc. All rights reserved.



605-815

Optional Chrome Strip

OPTIONAL CHROME TRIM

Two lengths of chrome trim (optional) has been provided. This trim has been supplied to be placed at the outer edge of the vent opening to add a finished appearance. Once preparation is complete, peel the red release liner from the precut trim and set in place, pressing firmly to set.

STEP 1.

Peel and stick optional chrome strip can be applied on the border of the metal screen or on the painted area next to it.

STEP 2.

Always do as a "dry-run" before removing release paper on the back side of the chrome tape.

STEP 3.

Clean the vent ridge with rubbing alcohol, swiipe adhesive promoter provided.

STEP 4.

Trim length in area that is least seen when looking at the screen.